

# bigHead SM8-B38A stainless steel 90 Degree Loop product range

Technical Data Sheet



## SM8-B38A



### Description

bigHead fastener with a 90 degree closed loop fixing, welded to a  $\varnothing$  38 mm cropped circular perforated Head. Suitable for surface bonding applications requiring a clip attachment or hooking point.

### Key features



Closed loop fixing



Perforated Head design



316 stainless steel construction, self colour finish

### Intended usage



Surface bonding, closed loop

*Alternative configurations may be possible using this product.*

*Please contact bigHead for further advice*

### Fastening functionality

Provides a closed loop attachment point, ideal for clips, hooks or similar secondary fasteners.



# bigHead SM8-B38A stainless steel 90 Degree Loop

## product range

Technical Data Sheet



### Nominal dimensions (mm)

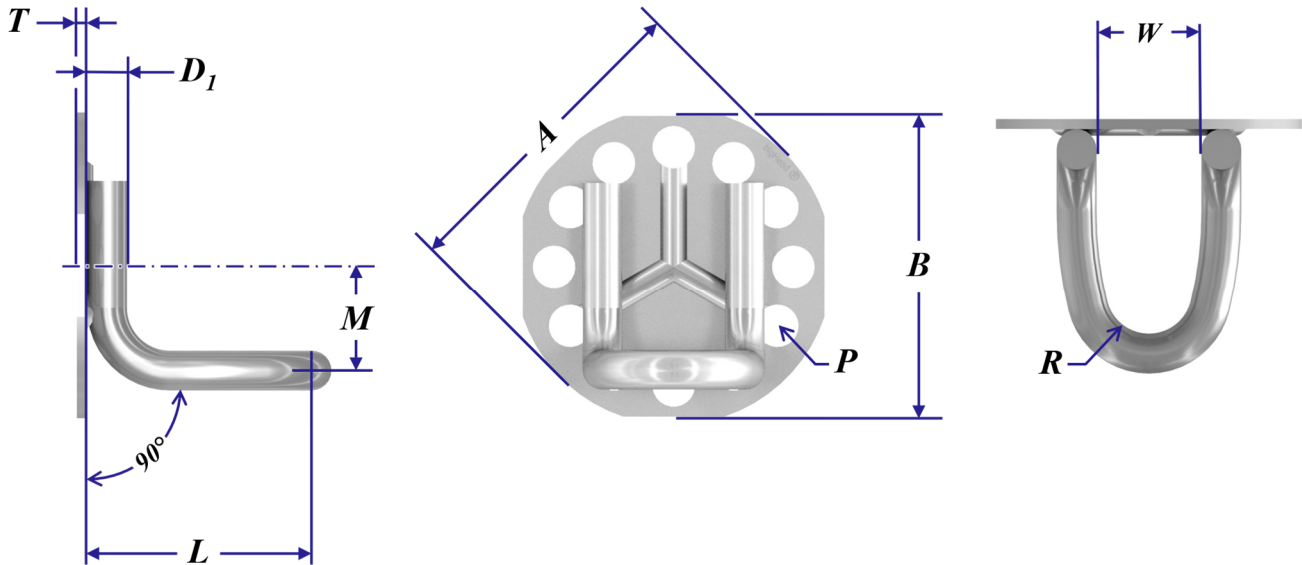

Product code	D1	A (Ø)	B	T	L	M	W	R	Typical min. weight (g)
SM8-B38A-5X90D	5	38	36	1.2	26.5	12.5	12	R5	22

#### Common to all:

P - 12 perforation holes, equally spaced circular array

### Design & application guidance

#### Loadability (Weld)

Max. tensile load (kN)  
3.7

Weld load limit (WLL):

*To avoid failure of the bigHead product, do not exceed stated loadability limit.*

*bigHead is not liable for failures arising from excessive tensile loading of their products.*

#### Loading considerations

Note: weld load limit (WLL) applies only to the indicated loading direction (F). Loadability for this product may vary in different directions. Always determine application suitability by appropriate testing.

**Please contact bigHead for further guidance if you are unsure about these topics.**

## Disclaimer

---

The information within this document is for guidance purposes only and does not constitute a guarantee or warranty of any kind.

bigHead cannot accept liability for performance arising from use of these products.

Always perform appropriate testing and evaluation to determine application suitability.

Illustrations and diagrams are for illustrative purposes only and may differ from actual products.

## Further information & contact details

---

For further information about these products, or for technical support inquiries, please contact us:

[www.bighead.co.uk/the-techub/](http://www.bighead.co.uk/the-techub/)

[TecH@bighead.co.uk](mailto:TecH@bighead.co.uk)

+44 (0)1202 583 696

**bigHead Bonding Fasteners Ltd**

Unit 1, Black Moor Business Park

36A Black Moor Road

Ebblake Industrial Estate

Verwood

Dorset

BH31 6BB